

B.M.#27 - R.R. SPK. IN 24" ELM 375.40' LT.
STA. 1076+77.80 AT C SURVEY ELEV.=1055.78

DESCRIPTION	REVISIONS	DATE

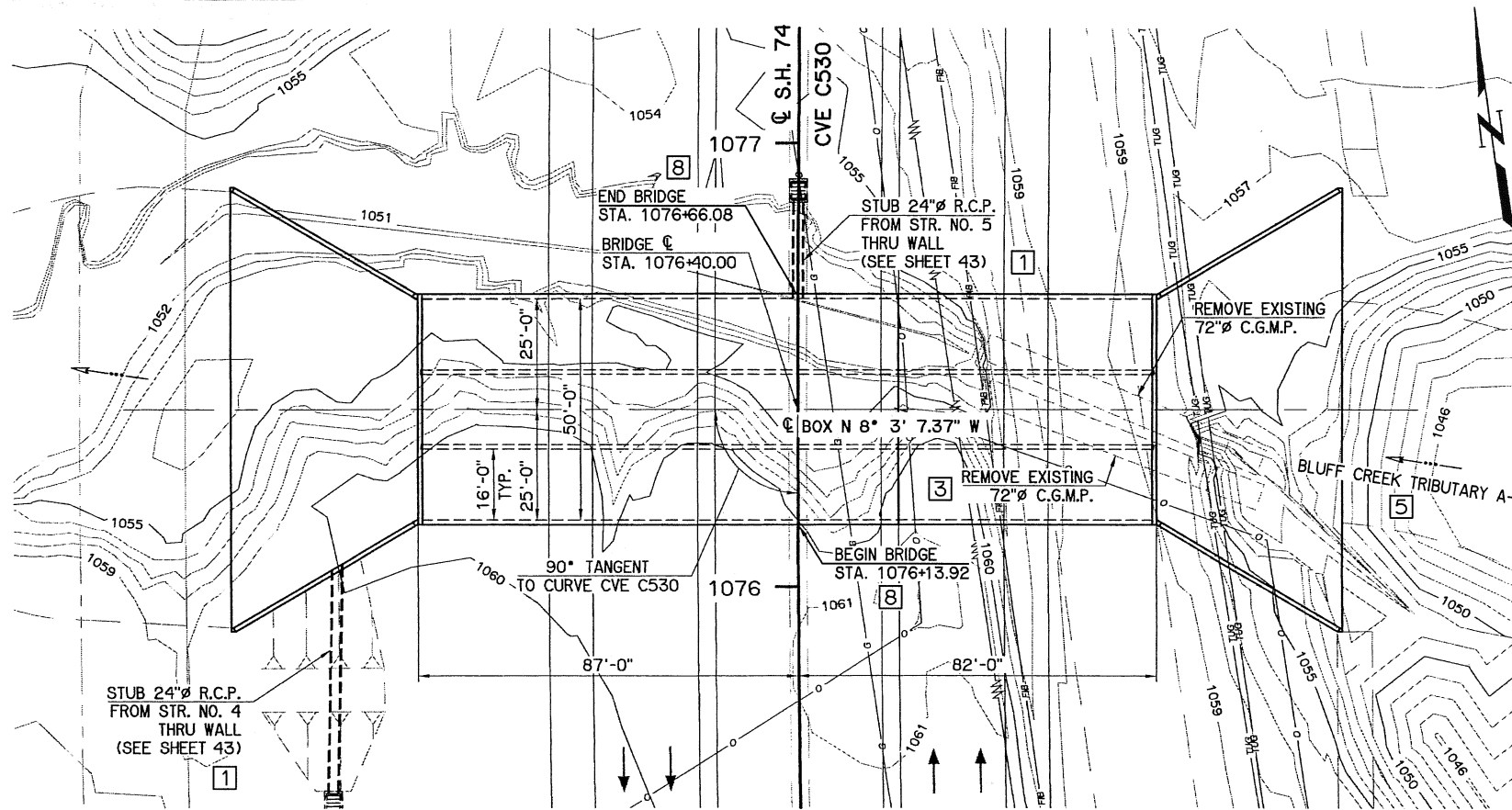

B.M.#26 - TOP "T" POST FLUSH WITH GROUND 359' LT.
STA. 1069+49.30 AT C SURVEY ELEV.=1072.46

PLAN

NOTE: ALL STATIONS SHOWN ARE ALONG
C S.H. 74 UNLESS NOTED OTHERWISE.

CURVE DATA
CVE. No. C530
C S.H. 74
P.I. STA. 1071+19.92
 $\Delta = 08^{\circ}49'07.80''$ RT.
R = 7639.4373'
D = 00^{\circ}45'00.00"
T = 589.0856'
L = 1175.8443'
Ch = 1174.6839'
E = 22.6789'
e = 0.06
S = 0.028'/'
V = 70 MPH

HYDRAULIC DATA

DRAINAGE AREA	1.57 SQ.MI.
RDWY. OVERTOPPING ELEV	1068.40 FT
Q2	1170 CFS
V2	3.87 FPS
Q2 COMP WATER SURFACE ELEV	1057.92 FT
Q5	1720 CFS
V5	4.90 FPS
Q5 COMP WATER SURFACE ELEV	1059.16 FT
Q10	2110 CFS
V10	5.54 FPS
Q10 COMP WATER SURFACE ELEV	1059.93 FT
Q25	2660 CFS
V25	6.51 FPS
Q25 COMP WATER SURFACE ELEV	1060.79 FT
Q50	3100 CFS
V50	7.33 FPS
Q50 COMP WATER SURFACE ELEV	1061.38 FT
Q100	3590 CFS
V100	8.25 FPS
Q100 COMP WATER SURFACE ELEV	1062.00 FT
Q500	4850 CFS
V500	10.34 FPS
Q500 COMP WATER SURFACE ELEV	1063.34 FT

INDEX OF SHEETS - BRIDGE "D"

13. PAY QUANTITIES AND GENERAL NOTES (BRIDGE) [7]
B1. GENERAL PLAN AND ELEVATION - BRIDGE "D"
THE FOLLOWING STANDARDS WILL BE REQUIRED:
RCB-C3-16(2-8)-02E
RCB-E3-H12-0-1-01E
RCB-E3-H12-0-2-01E
RCB-CW3-D4-0-01E
SBI-4-2

DESIGN DATA

SPECIFICATION:
DESIGNED IN ACCORDANCE WITH 2007 AASHTO LRFD
BRIDGE DESIGN SPECIFICATION AND INTERIM
SPECIFICATIONS 2008.

LOADING:
HL-93
OKLAHOMA OVERLOAD (STRENGTH-II LOAD COMBINATION)

UNIT STRESSES:
CLASS AA CONCRETE F'C = 4,000 PSI
REINFORCING STEEL (GR. 60) F'Y = 60,000 PSI

4 - #5 EA. FACE PLACE
AS SHOWN LENGTH OF #5
BAR EQUALS DIA. OF
PENETRATION PLUS 4'-0"

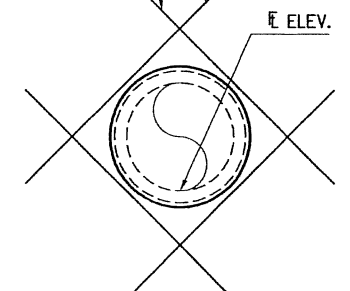

**DETAIL OF OPENING IN
WALL OR WING WALL**

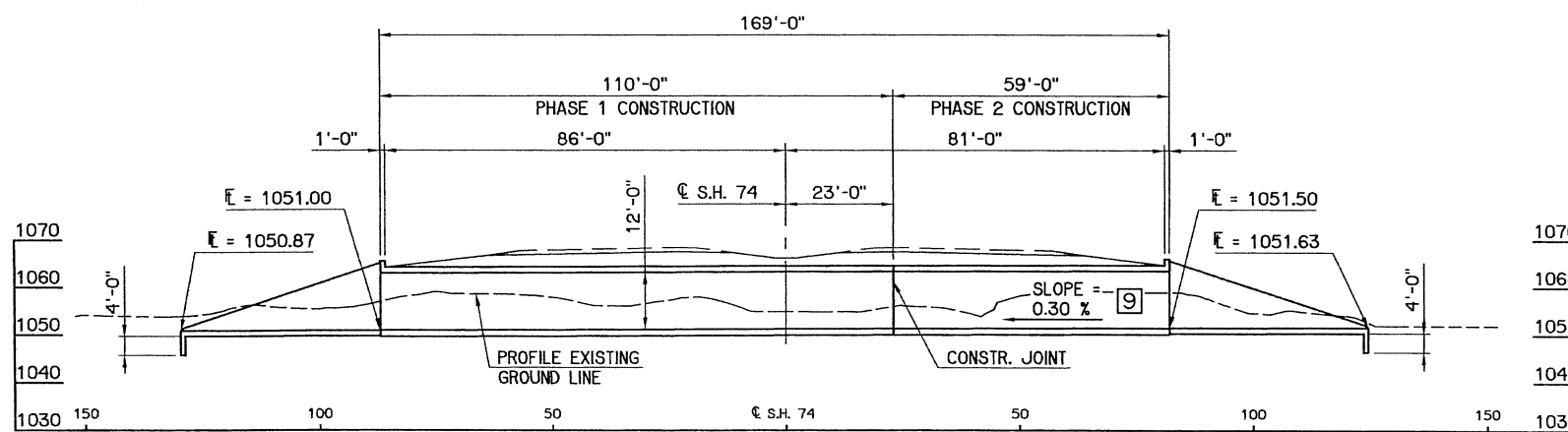

ELEVATION

THIS SEAL AND SIGNATURE COVERS THE FOLLOWING UPDATES:

PREPARED AND SUBMITTED BY:
TRIAD DESIGN GROUP
CA# 1759 EXP. 6-30-2019

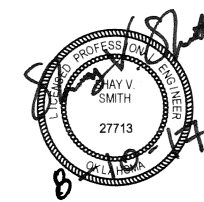

- 1 SHEET NUMBER UPDATED
- 2 DATE REMOVED
- 3 PIPE SIZE UPDATED
- 4 QUANTITY UPDATED
- 5 TRIBUTARY NAME ADDED
- 6 ODOT STANDARD DRAWING ADDED
- 7 SHEET NAME UPDATED
- 8 STATION ADDED
- 9 SLOPE ADDED

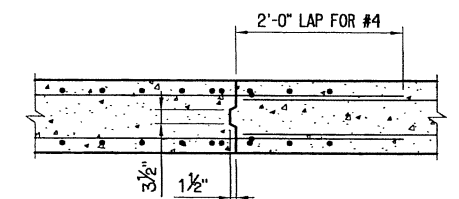

TRANSVERSE CONSTRUCTION JOINT

QUANTITIES - BRIDGE "D"				
DESCRIPTION	UNIT	BARREL [1]	END SECTIONS [2]	TOTAL
UNCLASSIFIED EXCAVATION	CY	4,030.00	0.00	4,030.00
STRUCTURAL EXCAVATION UNCLASSIFIED	CY	655.20	0.00	655.20
[1] [2] CLASS AA CONCRETE	CY	1,156.00	368.40	1,524.40
[1] [2] REINFORCING STEEL	LB	208,420.00	43,000.00	251,420.00

- [1] REFER STANDARDS TO DETERMINE BARREL LENGTH QUANTIFIED.
[2] QUANTITY INCLUDES BOTH END SECTIONS WITH CURTAIN WALL.



Design	SBH	S.H. 74	Oklahoma County
Drawn	SVS		
Checked	RM		
Approved			
Squad	TRIAD	State Job No. 14964(08)	Sheet No. B1

GENERAL PLAN AND ELEVATION - BRIDGE "D"
C STA. 1076+40.00 ; SKEW 00^{\circ}00'00" L.F.
3 CELL - 16'x12'x169' RCB WITH 2' FILL

12-15-2011